









KEY

-  Site Boundary
-  Location of Detail Drawing
- Proposed Shared pedestrian/cycle route with:
-  Existing concrete surface
-  Proposed aggregate surfacing (Refer to Drawing No. xx)
-  Proposed 'Addastone' surfacing (Refer to Drawing No. xx)
-  Proposed pedestrian route with aggregate surfacing (Refer to Drawing No. xx)
-  Proposed Signage - place name
-  Proposed Signage - directional
-  Proposed seating

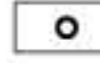

Whitehaven Coast Masterplan Proposals -  
Landscape Works, Detail Design

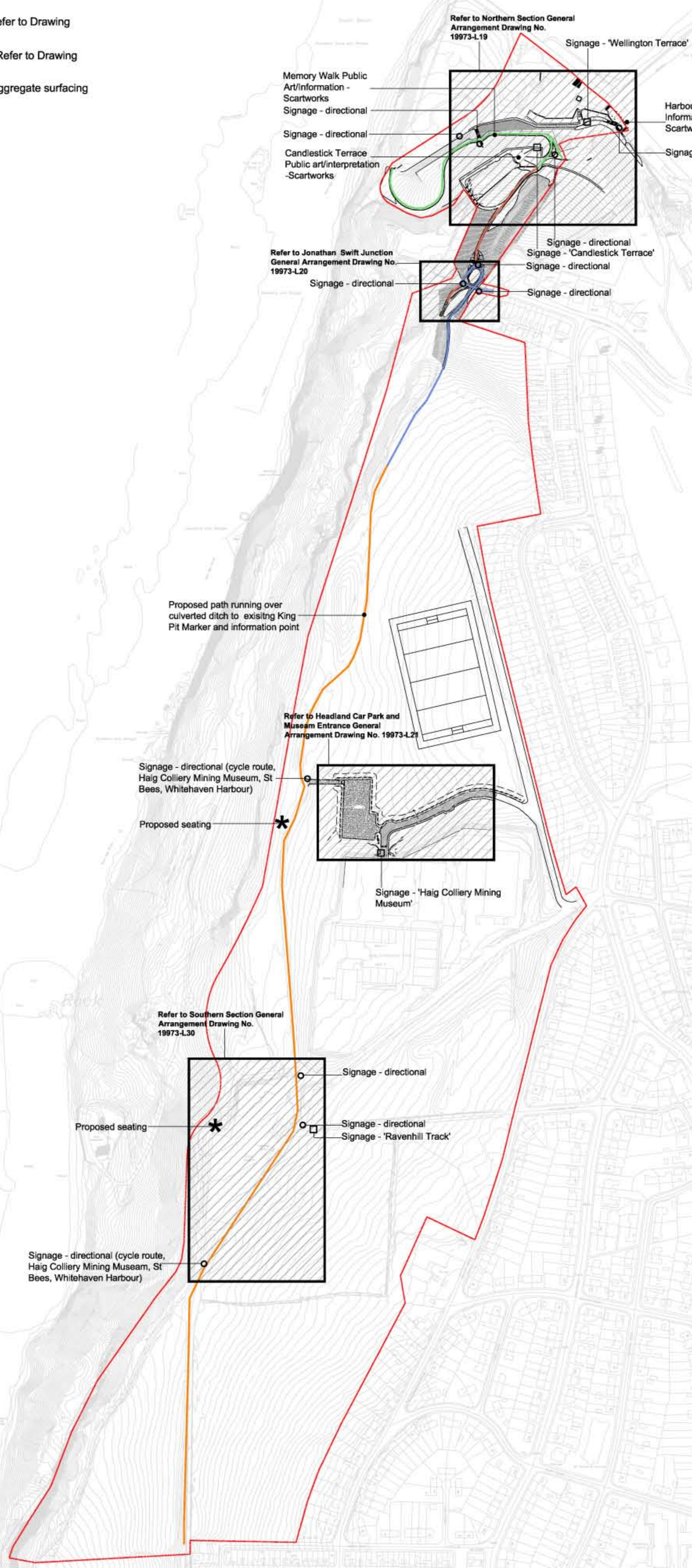
**Overall General Arrangement**

May 2007  
19973-L22.dwg sampr

